

1

Colocar referencia en la cara interior y atornillar.
Place the reference from the back side and screw.
Poser l'indicateur de position à la face postérieure de la porte et visser

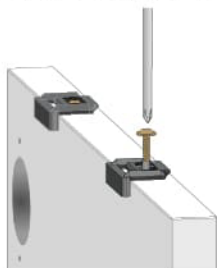

2

Quitar referencias
Remove references
Retirer les indicateurs de position



3

Aplicar adhesivo
Apply adhesive
Appliquer l'adhésif

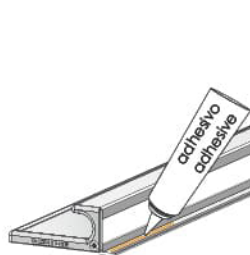

4

Colocar desde la cara exterior
Place the handle from the front side.
S'installer le poignée retenant par la face extérieure de la porte

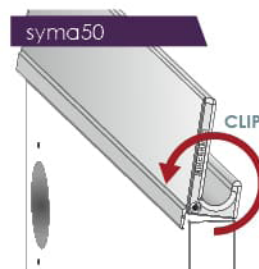

5

Girar hacia la cara interior hasta oír ¡clip!
Push handle down towards the back side until you hear Clip!
Tourner jusqu'au clic

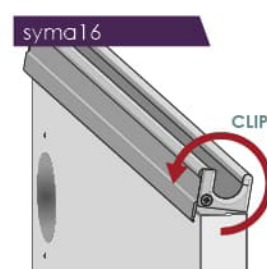

Medidas a considerar
Measurements to consider
Mesures à prendre en compte

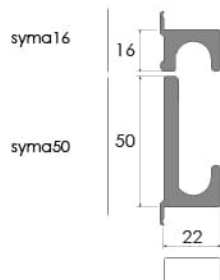

Longitud tirador - número de clips
Handle length - number of clips
Longueurs de poignée - numéro de clips

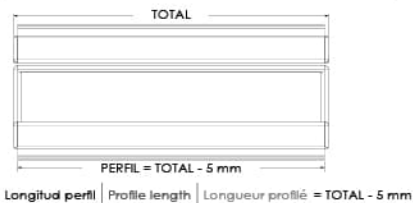

- 2 clips** — tiradores menores de 700 mm
handles under 700 mm
poignées inférieures à 700 mm
- 3 clips** — tiradores de 800 a 1600 mm
handles from 800 up to 1600 mm
poignées de 800 à 1600 mm
- 4 clips** — tiradores mayores de 1700 mm
handles longer than 1700 mm
poignées supérieures à 1700 mm

Componentes
Components
Composants

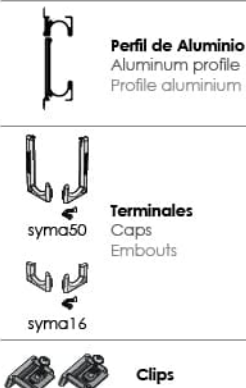

Acabados
Finishes
Finitions

- 35** plata mate
matt silver
argent mat
- 04** plata brillo
chrome effect
effet chrome
- 60** antracita
anthracite
anthracite
- 05** inox grata repulido
inox - champagne
inox - champagne
- 52/52M** negro brillo / negro mate
glass black / matt black
noir brillant / noir mat
- 01/01M** blanco brillo / blanco mate
gloss white / matt white
blanc brillant / blanc mat

Customization

Longitud lámina decorativa = longitud perfil - 1 mm

Decorative sheet length = profile length - 1 mm

Longueur lamme decoratif = longueur profilé - 1 mm

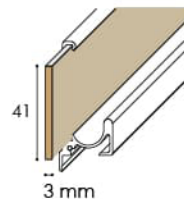

Grosor de la puerta superior a 18 mm
Door's thickness higher than 18 mm
Épaisseur de la porte supérieure à 18 mm